

KEY PRODUCT CHARACTERISTICS			
SAFETY COMPLIANCE	FIT/FUNCTION		
SIC CHECKPOINTS	F/F CHECKPOINTS		
NO. & TYPE	DESCRIPTION	RATIONALE	PTS

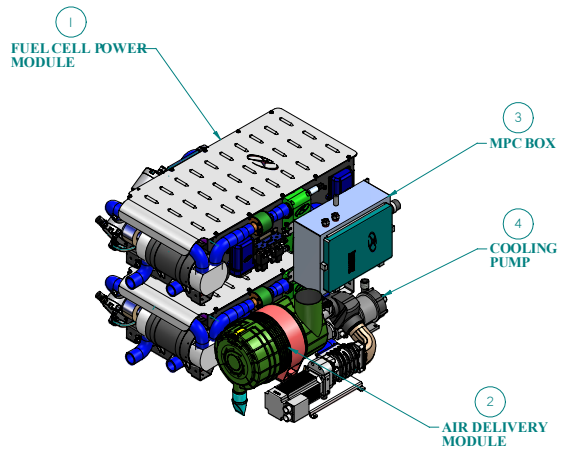

**1**  
**FUEL CELL POWER MODULE**  
 1964mm X 707mm X 673mm  
 Weight 280 kg

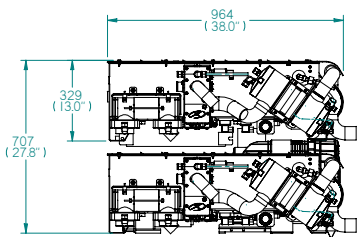
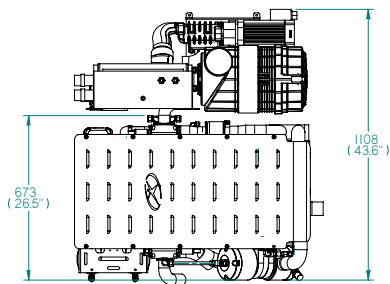
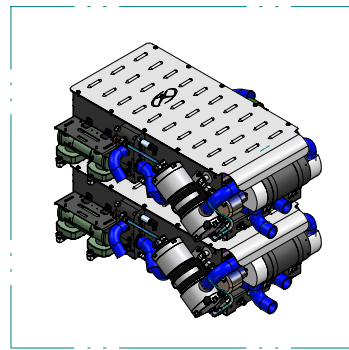

**2**  
**AIR DELIVERY MODULE**  
 1629mm X 428mm X 427mm  
 Weight 24 kg

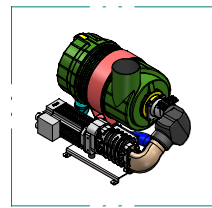

**3**  
**MPC BOX**  
 1459mm X 327mm X 188mm  
 Weight 12 kg

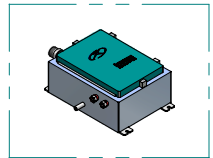

**4**  
**COOLING PUMP**  
 340mm X 180mm X 140mm  
 Weight 4.6 kg

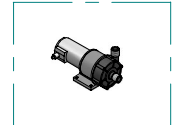

Packaging Options:

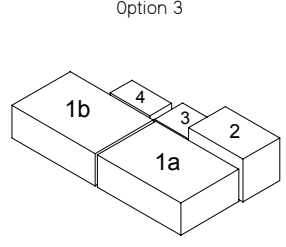
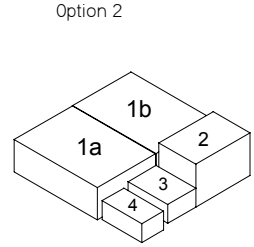
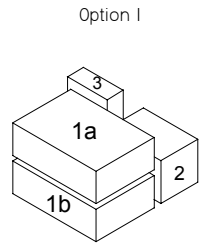

GENERAL NOTES:  
 1. COMPONENTS CAN BE MOUNTED IN OTHER CONFIGURATIONS

FINISH:			
MATERIAL:			
<small>HYDROGENICALLY COMPATIBLE MATERIALS</small> <small>ALL RIGHTS RESERVED</small>		<small>HYDROGENICALLY COMPATIBLE MATERIALS</small> <small>ALL RIGHTS RESERVED</small>	
		<b>65 KW FUEL CELL ENGINE</b> Option 1	DATE: _____ DRAWN: _____ CHECKED: _____ APPROVED: _____
JAN / 07 / 2005 114306_X1.dwg		1 : 10 114306	X1 PAGE 1 of 1

METRIC